

# DEKALB TOWNSHIP

## KISHWAUKEE LN & MANOR DR IMPROVEMENTS

### DEKALB COUNTY, ILLINOIS

#### SECTION NO: 15-04122-00-RS

#### 2015

#### INDEX OF SHEETS:

| SHEET NO. | DESCRIPTION  |
|-----------|--|
| 1         | COVER SHEET  |
| 2         | TYPICAL SECTIONS, SUMMARY OF QUANTITIES,<br>DETAILS & SCHEDULE OF QUANTITIES |
| 3         | DEMOLITION PLAN  |
| 4         | PLAN   |
| 5         | ELEVATIONS   |
| 6         | CROSS SECTIONS - KISHWAUKEE LANE   |
| 7         | CROSS SECTIONS - KISHWAUKEE LANE   |
| 8         | CROSS SECTIONS - MANOR DRIVE   |
| 9         | CROSS SECTIONS - MANOR DRIVE   |

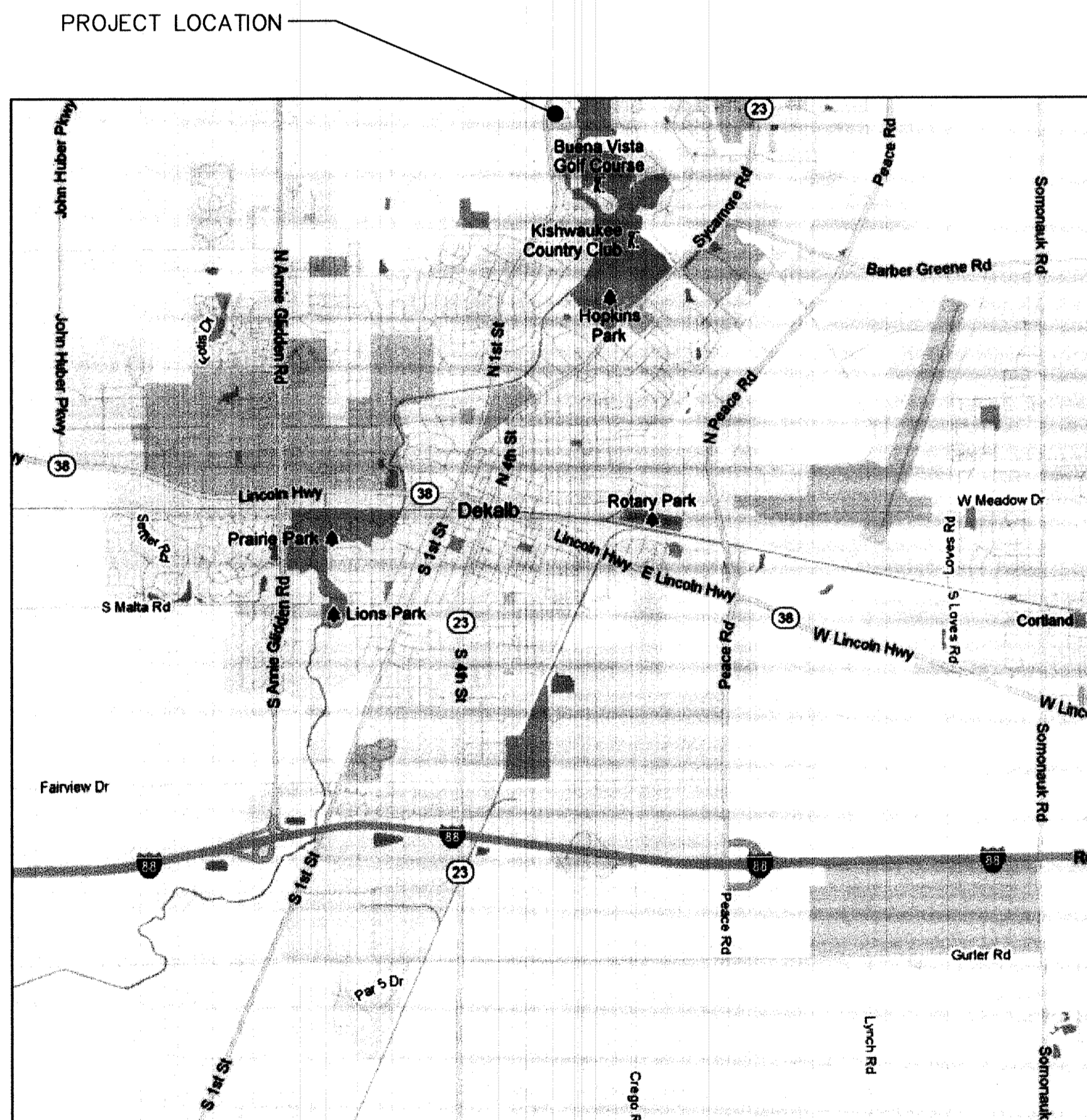

LOCATION MAP  
SCALE: N.T.S.

LENGTH OF IMPROVEMENT  
 KISHWAUKEE LANE = 744.16 FT (0.140 MILES) GROSS  
 KISHWAUKEE LANE = 716.05 FT (0.134 MILES) NET  
 MANOR DRIVE = 798.37 FT (0.151 MILES) GROSS  
 MANOR DRIVE = 768.25 FT (0.146 MILES) NET

| DESIGN CRITERIA            |                        |       |               |
|----------------------------|------------------------|-------|---------------|
| ROADWAY:                   | DESIGN CLASSIFICATION: | ADT:  | DESIGN SPEED: |
| KISHWAUKEE LN/<br>MANOR DR | LOCAL ROAD             | < 100 | 25 MPH        |

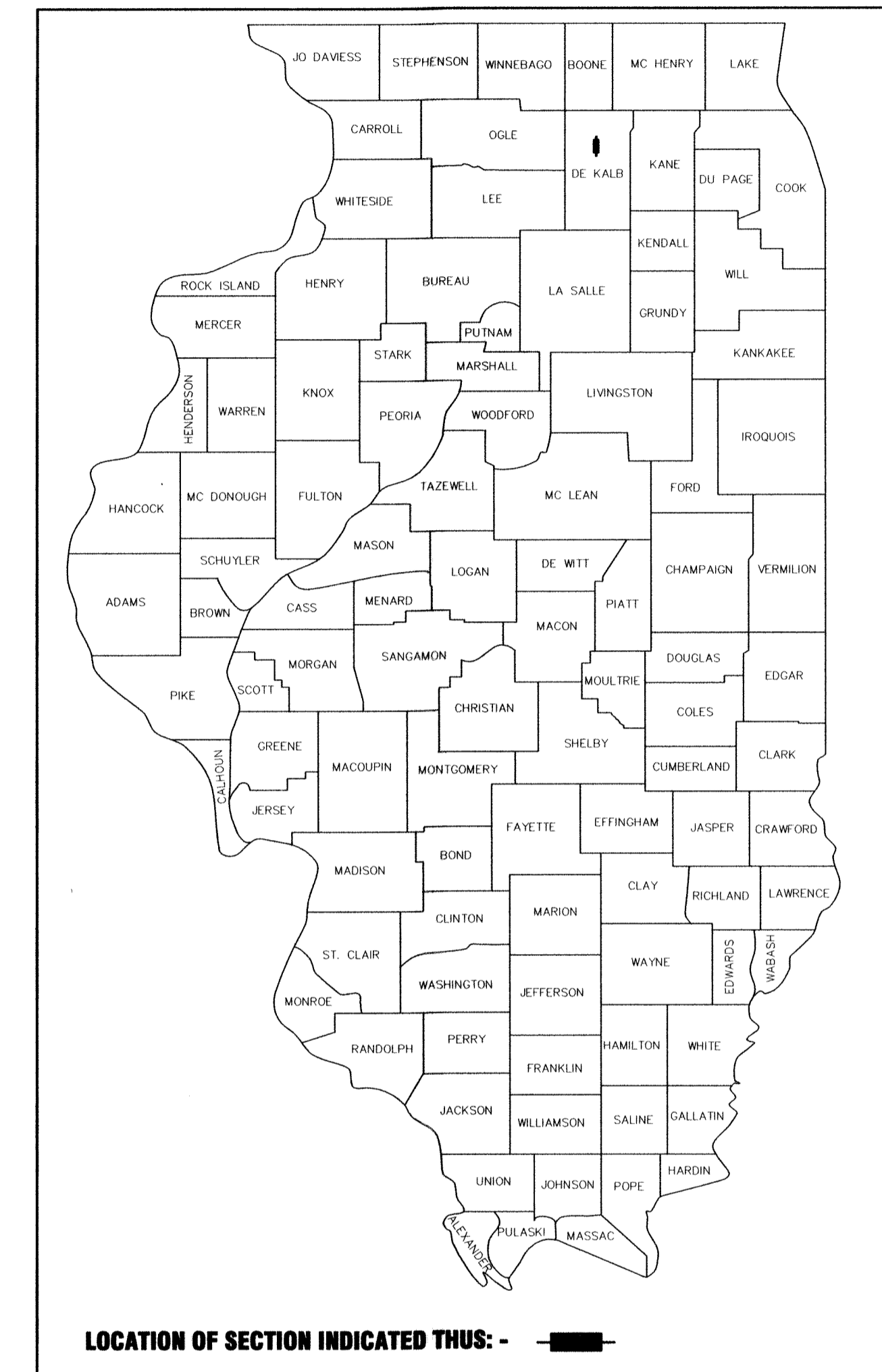
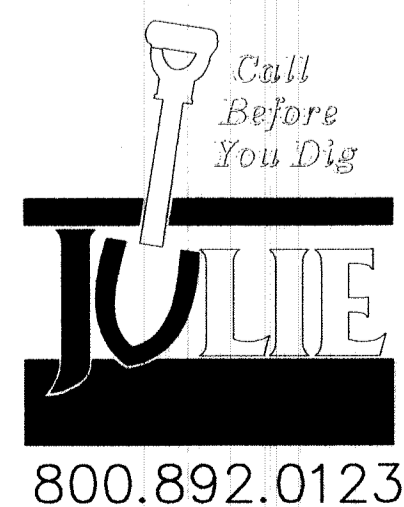

**DEKALB COUNTY HIGHWAY DEPARTMENT  
ENGINEERING DEPARTMENT**

APPROVED: APRIL 22 2015

*Nathan F. Schwartz*  
DEKALB COUNTY ENGINEER

APPROVED: April 22 2015

*Craig Smith*  
DEKALB TOWNSHIP ROAD COMMISSIONER



*Nathan F. Schwartz*  
DATE: 4/22/2015  
 NATHAN F. SCHWARTZ  
 DEKALB, ILLINOIS  
 ILLINOIS LICENSED PROFESSIONAL  
 ENGINEER NO. 062-055001  
 EXPIRES: 11/30/2015

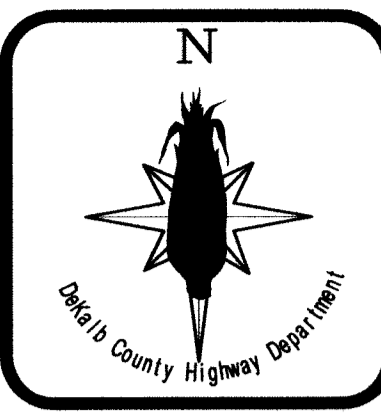

| REVISIONS:                     | DATE:     |
|--------------------------------|-----------|
| REVISION: FOR BID/CONSTRUCTION | 4/22/2015 |

DRAWN BY: KRF  
 DRAWING NAME: Kish-Manor Plans.dwg



KISHWAUKEE LANE & MANOR DRIVE  
 OF  
 CURB, GUTTER & SIDEWALK REPLACEMENT  
 FOR  
 DEKALB TOWNSHIP

SHEET TITLE:  
COVER SHEET

SECTION:  
15-04122-00-RS

DATE:  
02/25/2015

SHEET NO.  
1 of 9

## TYPICAL SECTION DEKALB ROAD DISTRICT

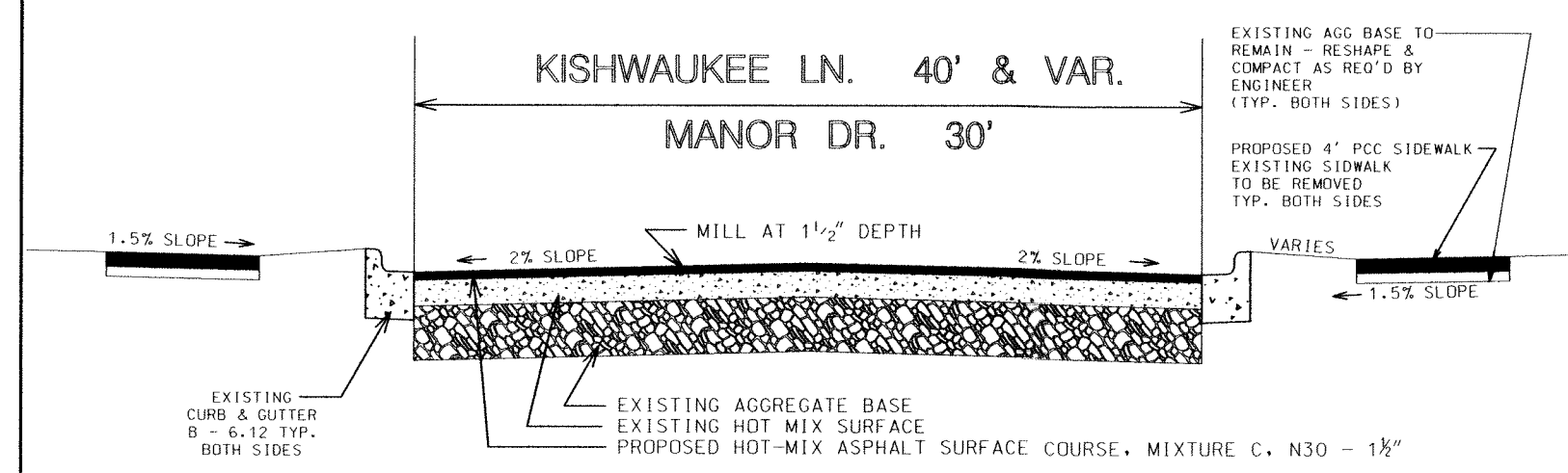

KISHWAUKEE LN. STA. 5+50 TO 7+44  
MANOR DR. STA. 6+00 TO 7+98

SECTION 15-04122-00-RS

## TYPICAL SECTION DEKALB ROAD DISTRICT

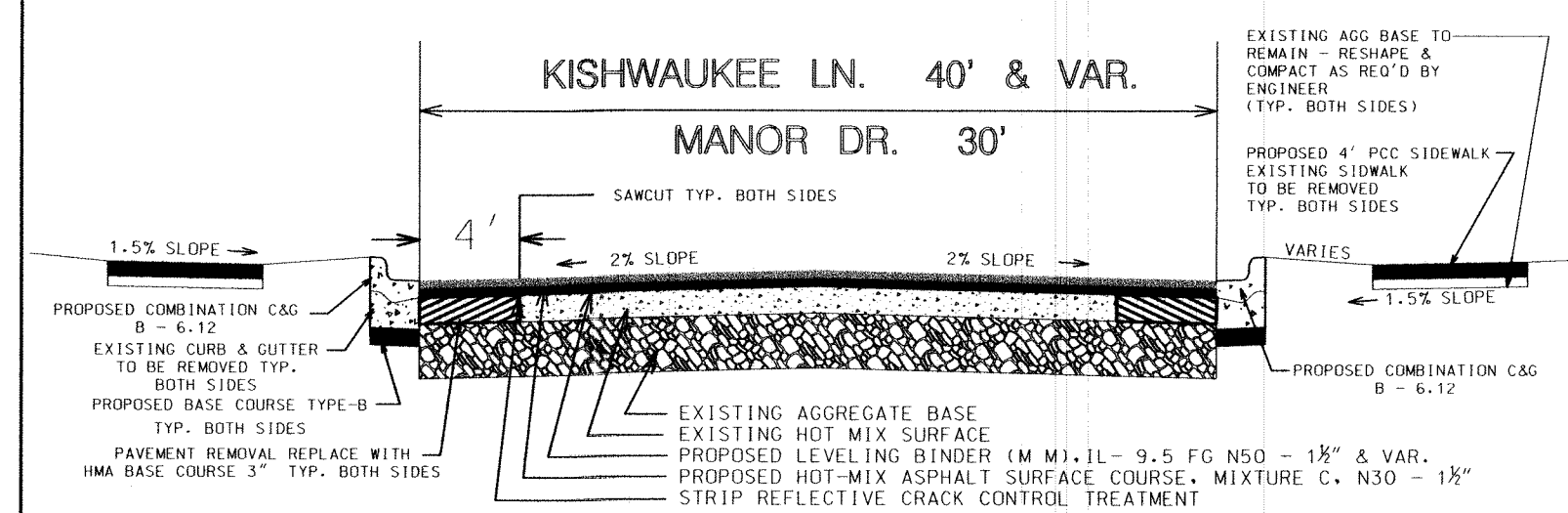

KISHWAUKEE LN. STA. 0+00 TO 5+50  
MANOR DR. STA. 0+00 TO 6+00

SECTION 15-04122-00-RS

## ENTRANCE DETAIL DEKALB ROAD DISTRICT

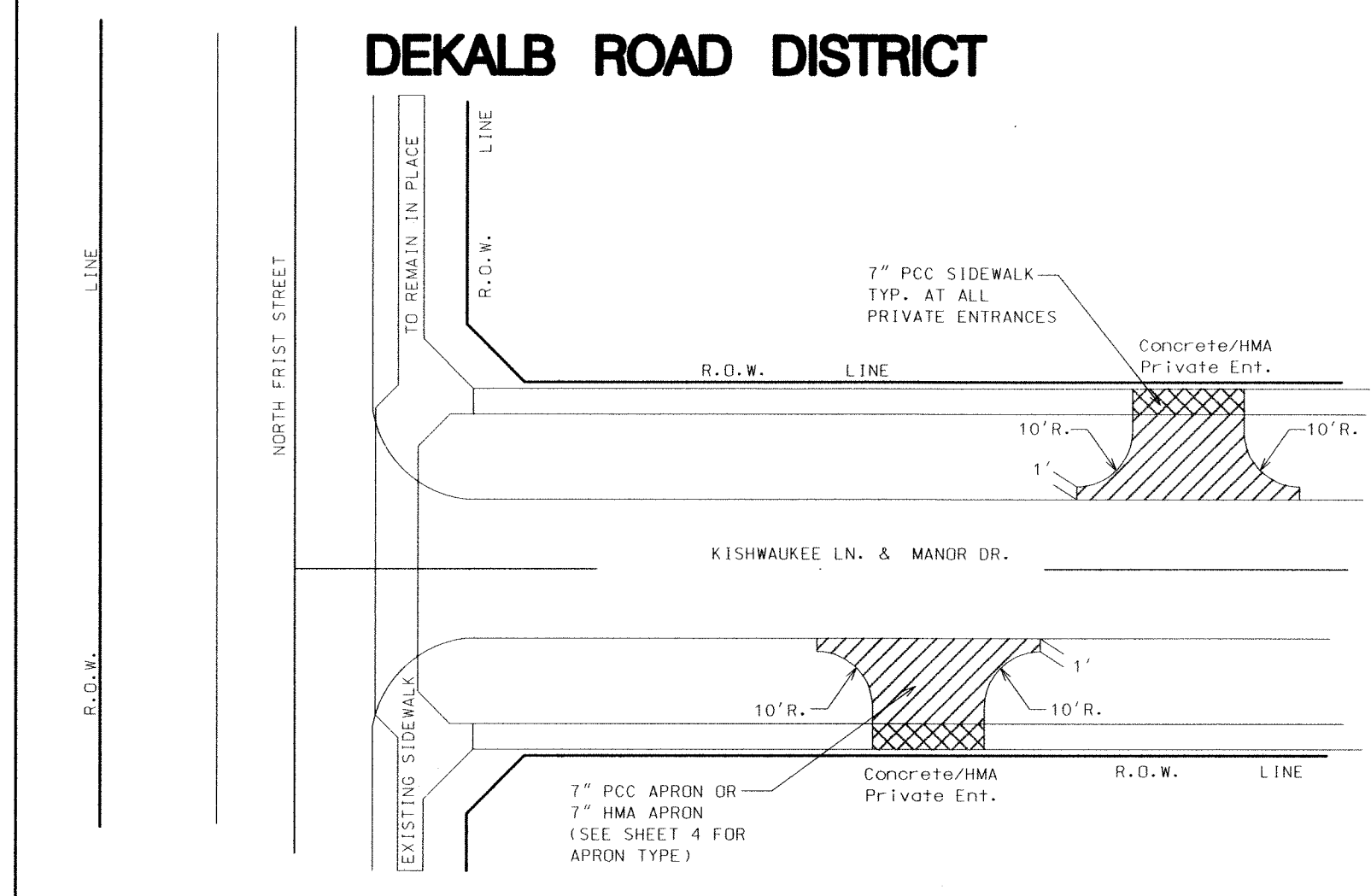

## JOINT TAPER DETAIL DEKALB ROAD DISTRICT

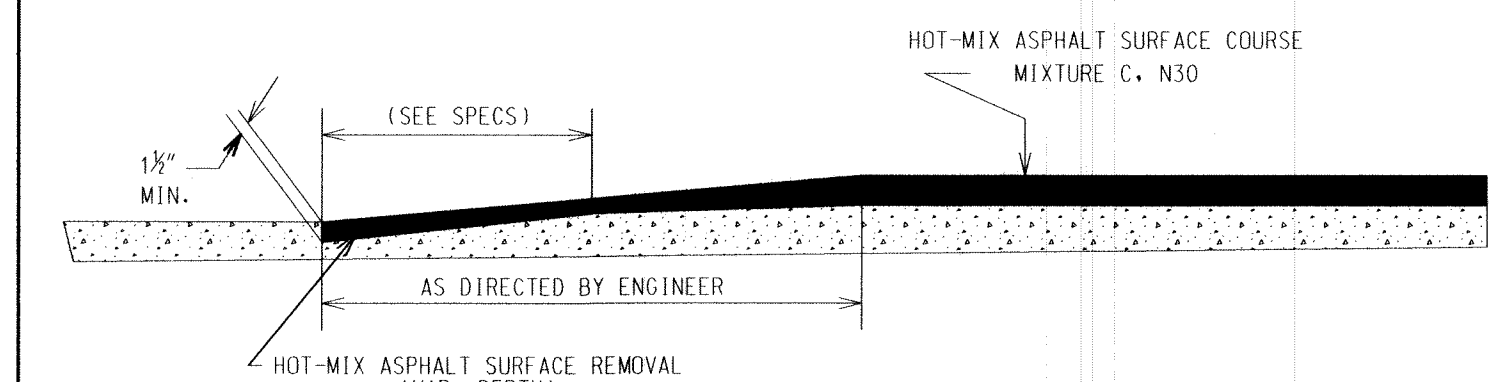

SECTION 15-04122-00-RS

## JOINT TAPER DETAIL DEKALB ROAD DISTRICT

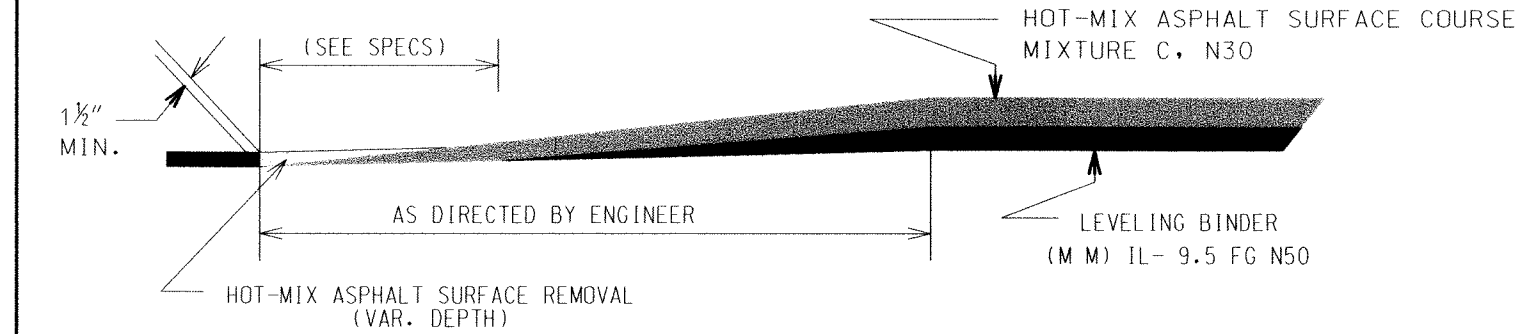

SECTION 15-04122-00-RS

## ENTRANCE SECTION DEKALB ROAD DISTRICT

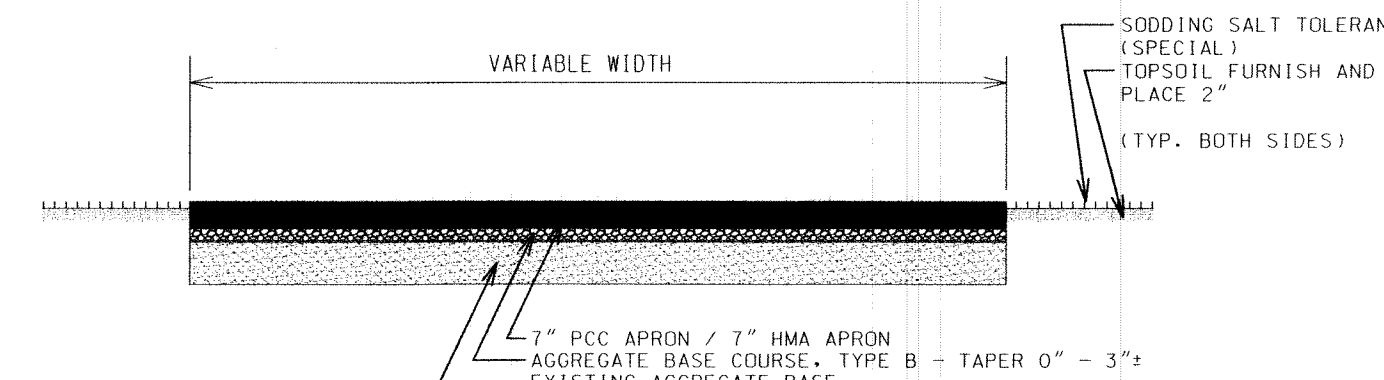

NOTE:  
SEE SHEET 4 FOR APRON MATERIAL

## SUMMARY OF QUANTITIES

| ITEM:   | UNIT: | QTY:  |
|---|-------|-------|
| SODDING SALT TOLERANT (SPECIAL)                 | SQ YD | 2012  |
| AGGREGATE BASE COURSE, TYPE B                   | TON   | 150   |
| BITUMINOUS MATERIALS (PRIME COAT)               | POUND | 3531  |
| HOT-MIX ASPHALT BASE COURSE 3" (SPECIAL)        | SQ YD | 960   |
| LEVELING BINDER (MACHINE METHOD), IL 9.5 FG N50 | TON   | 490   |
| HOT-MIX ASPHALT SURFACE COURSE, MIX "C" N30     | TON   | 490   |
| HOT-MIX ASPHALT SURFACE REMOVAL, 1.5"           | SQ YD | 1515  |
| HOT-MIX ASPHALT SURFACE REMOVAL, VARIABLE DEPTH | SQ YD | 405   |
| STRIP REFLECTIVE CRACK CONTROL TREATMENT        | FOOT  | 2159  |
| COMBINATION CURB & GUTTER REMOVAL               | FOOT  | 2159  |
| COMBINATION CURB & GUTTER B-6:12                | FOOT  | 2159  |
| PAVEMENT REMOVAL                                | SQ YD | 960   |
| PCC SIDEWALK 5 INCH                             | SQ FT | 9348  |
| PCC SIDEWALK 7 INCH                             | SQ FT | 1488  |
| SIDEWALK REMOVAL                                | SQ FT | 10836 |
| PCC DRIVEWAY PAVEMENT 7 INCH                    | SQ YD | 345   |
| DRIVEWAY PAVEMENT REMOVAL                       | SQ YD | 464   |
| TEMPORARY RAMP                                  | SQ YD | 155   |
| TOPSOIL FURNISH AND PLACE 2"                    | SQ YD | 2012  |
| SUPPLEMENTAL WATERING                           | UNIT  | 100   |
| MAN HOLE TO BE ADJUSTED                         | EACH  | 1     |
| INLET PROTECTION                                | EACH  | 5     |

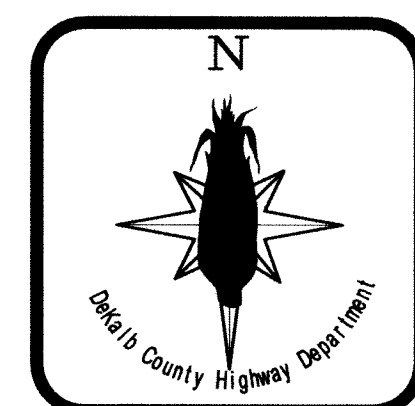

| REVISIONS:           | DATE:     |
|----------------------|-----------|
| REVISION:            | 4/22/2015 |
| FOR BID/CONSTRUCTION |           |

DRAWN BY:  
KRF  
DRAWING NAME:  
Kish-Manor  
Plans.dwg



KISHWAUKEE LANE & MANOR DRIVE  
OF  
CURB, GUTTER & SIDEWALK REPLACEMENT  
FOR  
DEKALB TOWNSHIP

### HOT MIX ASPHALT MIXTURE REQUIREMENTS

| DESCRIPTION:                               | MIX TYPE  | % AIR VOIDS @NDES | PG GRADE | FRICTION AGG |
|--|-----------|-------------------|----------|--------------|
| HOT MIX ASPHALT BASE COURSE, 3" (SPECIAL)  | IL-19.0mm | 4%050 GYR         | 64-22    | N/A          |
| HOT MIX ASPHALT LEVEL BINDER               | IL-19.0mm | 4%050 GYR         | 64-22    | N/A          |
| HOT MIX ASPHALT SURFACE COURSE MIX "C" N30 | IL-9.5mm  | 4%050 GYR         | 64-22    | C            |

SHEET TITLE:  
TYPICAL  
SECTIONS &  
SUMMARY OF  
QUANTITIES

SECTION:  
15-04122-01-RS

DATE:  
02/25/2015

SHEET NO.  
2 of 9

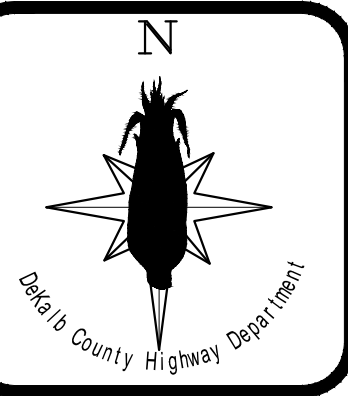

|                               |           |
|-------------------------------|-----------|
| REVISIONS:                    | DATE:     |
| REVISION FOR BID/CONSTRUCTION | 4/22/2015 |

DRAWN BY:  
KRF



KISHWAUKEE LANE & MANOR DRIVE  
OF  
CURB, GUTTER & SIDEWALK REPLACEMENT  
FOR  
DEKALB TOWNSHIP

SHEET TITLE:  
DEMO  
KISHWAUKEE \ MANOR

SECTION:  
15-04122-00-RS

DATE:  
02/25/2015

SHEET NO.  
3 of 9

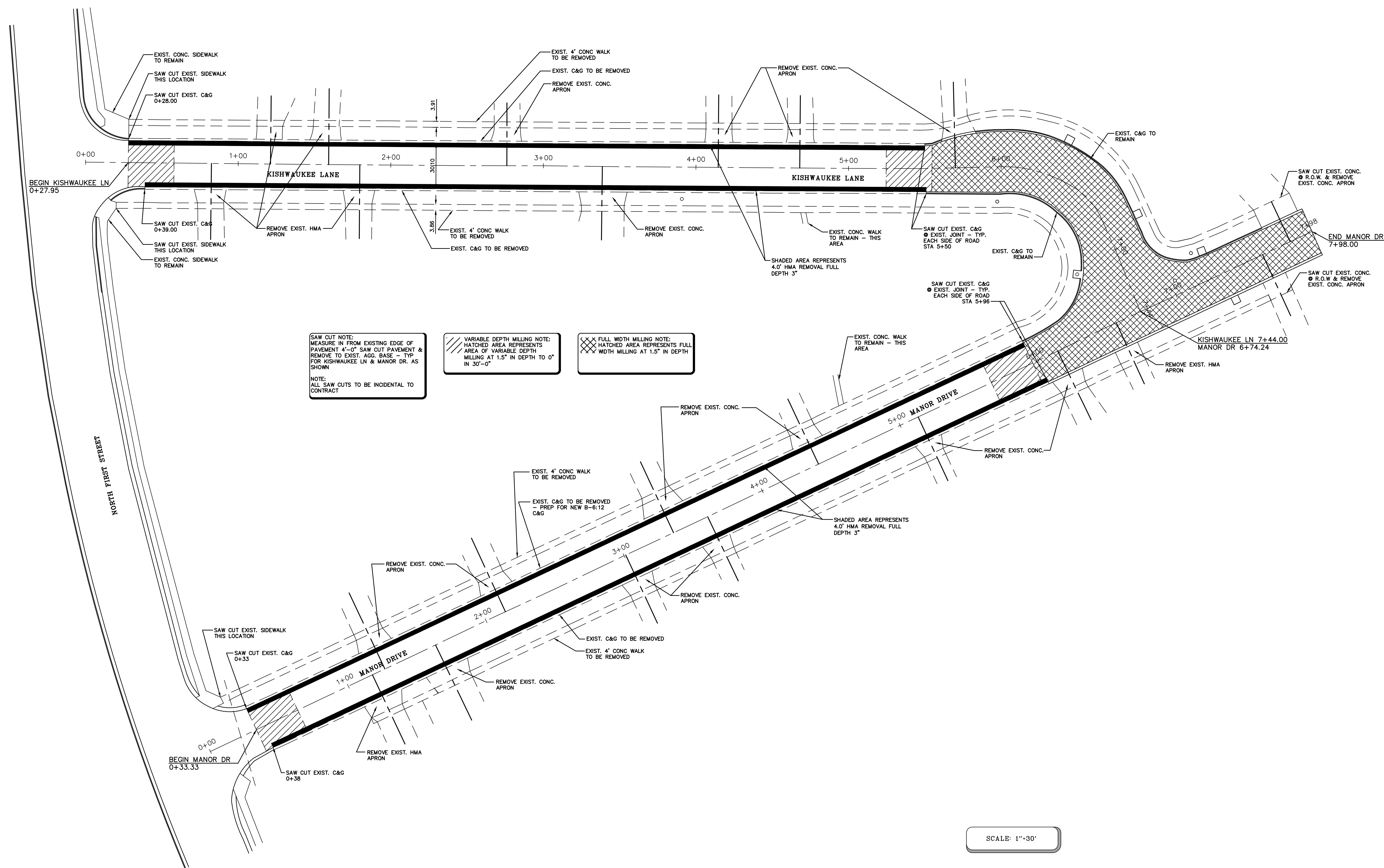

**SAW CUT NOTE:**  
MEASURE IN FROM EXISTING EDGE OF PAVEMENT 4'-0" SAW CUT PAVEMENT & REMOVE TO EXIST. AGG. BASE - TYP FOR KISHWAUKEE LN & MANOR DR. AS SHOWN  
NOTE: ALL SAW CUTS TO BE INCIDENTAL TO CONTRACT

**VARIABLE DEPTH MILLING NOTE:**  
HATCHED AREA REPRESENTS AREA OF VARIABLE DEPTH MILLING AT 1.5" IN DEPTH TO 0" IN 30'-0"

**FULL WIDTH MILLING NOTE:**  
HATCHED AREA REPRESENTS FULL WIDTH MILLING AT 1.5" IN DEPTH

SCALE: 1"=30'

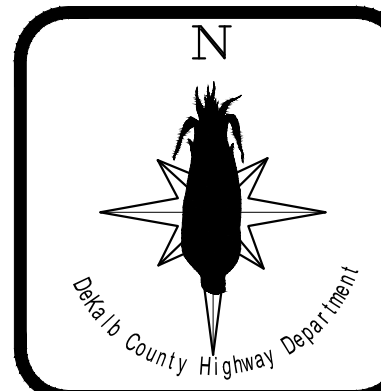

|                      |           |
|----------------------|-----------|
| REVISIONS:           | DATE:     |
| REVISION:            | 4/22/2015 |
| FOR BID/CONSTRUCTION |           |

DRAWN BY:  
KRF

DRAWING NAME:  
Kish-Manor  
Plans.dwg



KISHWAUKEE LANE & MANOR DRIVE  
OF  
CURB, GUTTER & SIDEWALK REPLACEMENT  
FOR  
DEKALB TOWNSHIP

SHEET TITLE:  
PLAN  
KISHWAUKEE \\  
MANOR

SECTION:  
15-04122-00-RS

DATE:  
02/25/2015

SHEET NO.  
4 of 9

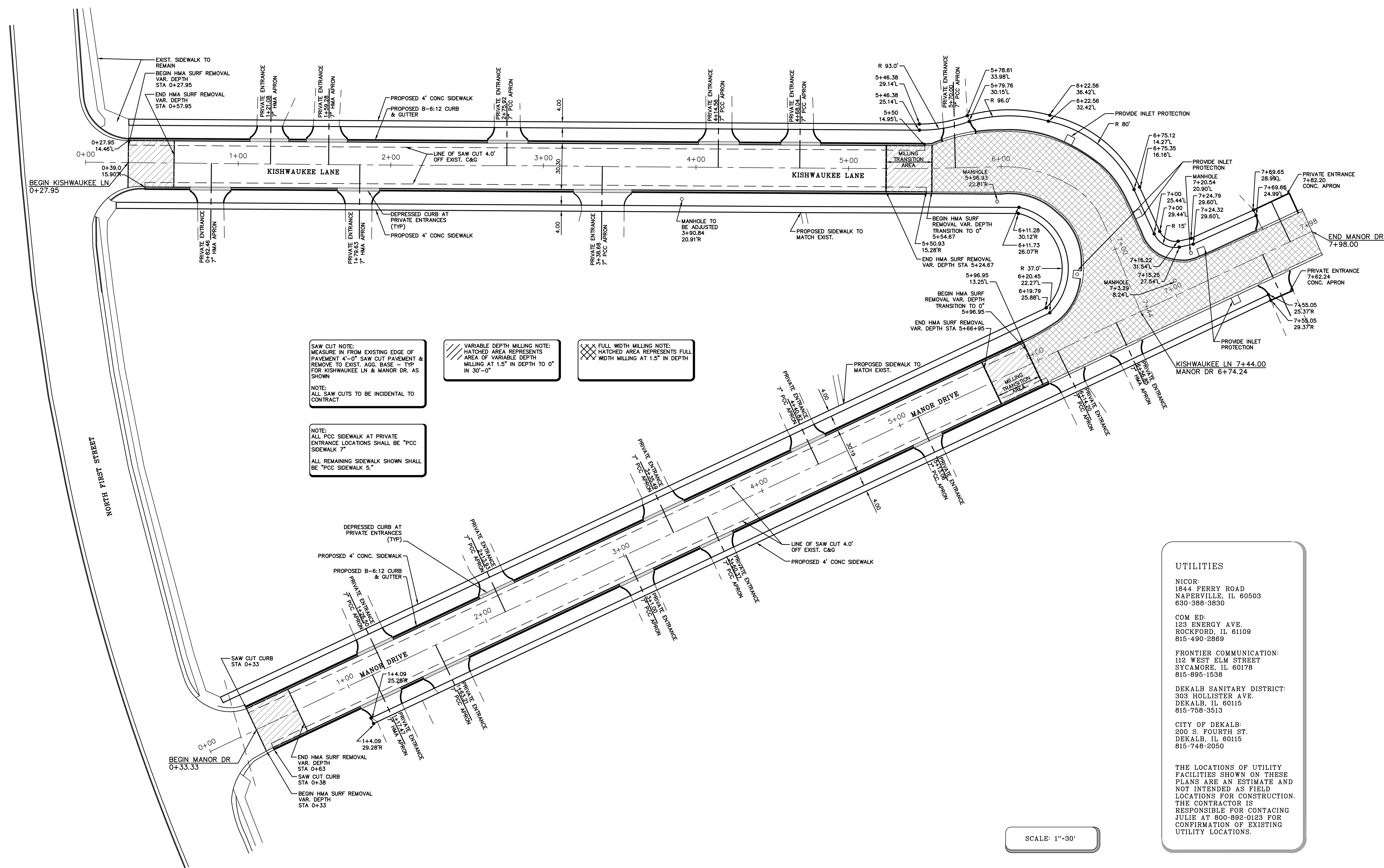

**SAW CUT NOTE:**  
MEASURE IN FROM EXISTING EDGE OF PAVEMENT 4'-0" SAW CUT PAVEMENT & REMOVE TO EXIST. AGG. BASE - TYP FOR KISHWAUKEE LN & MANOR DR. AS SHOWN

**NOTE:**  
ALL SAW CUTS TO BE INCIDENTAL TO CONTRACT

**NOTE:**  
ALL PCC SIDEWALK AT PRIVATE ENTRANCE LOCATIONS SHALL BE "PCC SIDEWALK 5"

ALL REMAINING SIDEWALK SHOWN SHALL BE "PCC SIDEWALK 5"

**VARIABLE DEPTH MILLING NOTE:**  
HATCHED AREA REPRESENTS AREA OF VARIABLE DEPTH MILLING AT 1.5" IN DEPTH TO 0" IN 30'-0"

**FULL WIDTH MILLING NOTE:**  
HATCHED AREA REPRESENTS FULL WIDTH MILLING AT 1.5" IN DEPTH

**UTILITIES**

NICOR:  
1844 FERRY ROAD  
NAPERVILLE, IL 60503  
630-388-3830

COM ED:  
123 ENERGY AVE.  
ROCKFORD, IL 61109  
815-490-2869

FRONTIER COMMUNICATION:  
112 WEST ELM STREET  
SYCAMORE, IL 60178  
815-895-1538

DEKALB SANITARY DISTRICT:  
303 HOLLISTER AVE.  
DEKALB, IL 60115  
815-758-3513

CITY OF DEKALB:  
200 S. FOURTH ST.  
DEKALB, IL 60115  
815-748-2050

THE LOCATIONS OF UTILITY FACILITIES SHOWN ON THESE PLANS ARE AN ESTIMATE AND NOT INTENDED AS FIELD LOCATIONS FOR CONSTRUCTION. THE CONTRACTOR IS RESPONSIBLE FOR CONTACTING JULIE AT 800-892-0123 FOR CONFIRMATION OF EXISTING UTILITY LOCATIONS.

SCALE: 1"=30'

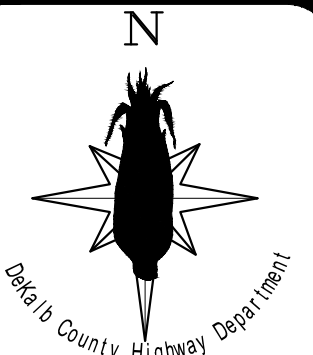

| REVISIONS:             | DATE:     |
|------------------------|-----------|
| FOR BID / CONSTRUCTION | 4/22/2015 |

DRAWN BY:  
KRF  
DRAWING NAME:  
Kish-Manor  
Plans.dwg



KISHWAUKEE LANE & MANOR DRIVE  
OF  
CURB, GUTTER & SIDEWALK REPLACEMENT  
FOR  
DEKALB TOWNSHIP

SHEET TITLE:  
ELEVATIONS  
KISHWAUKEE \ MANOR

SECTION:  
15-04122-00-RS

DATE:  
02/25/2015

SHEET NO.  
5 of 9

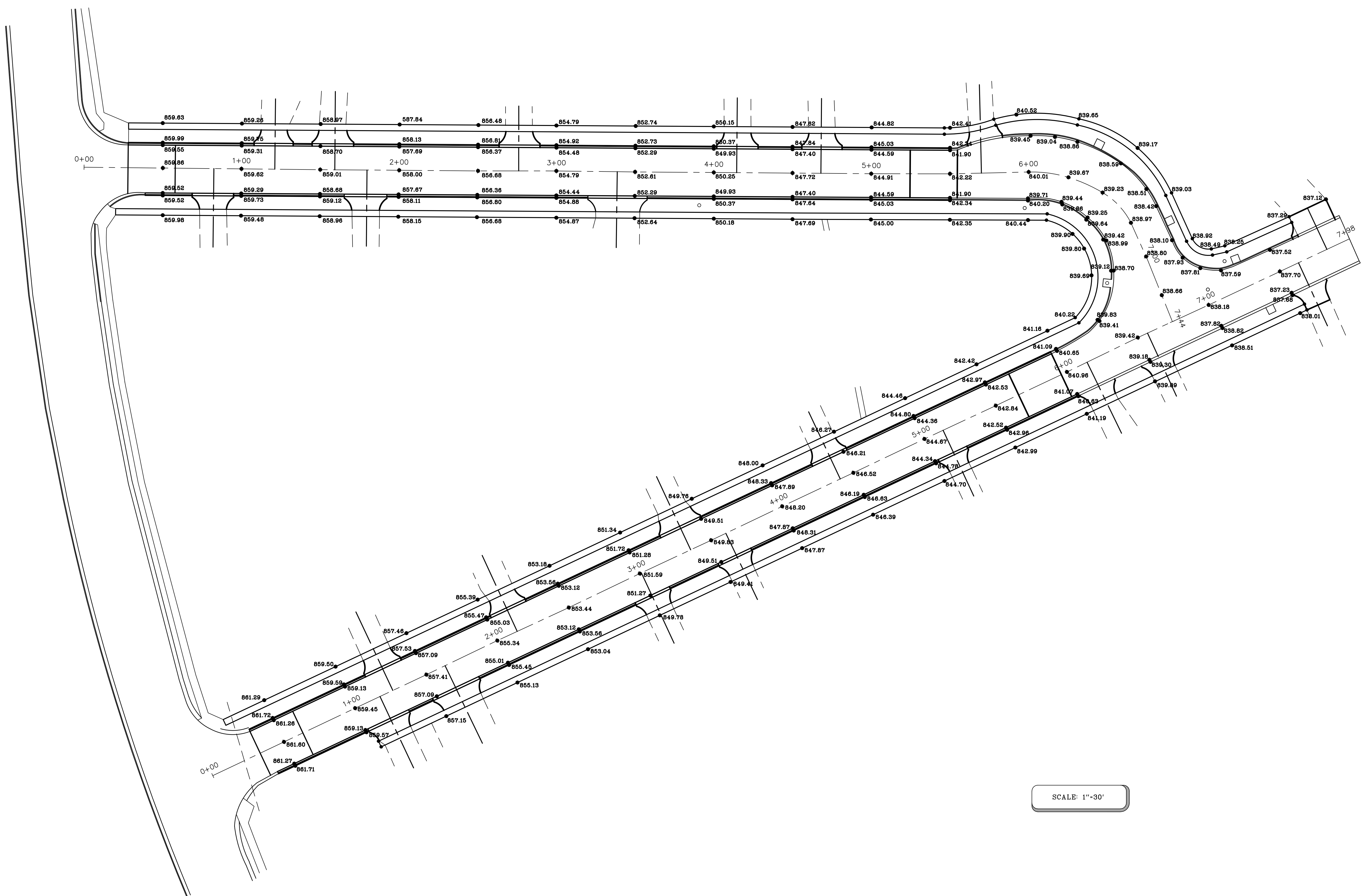

SCALE: 1"=30'

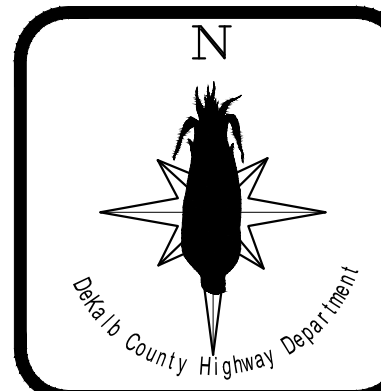

|                       |           |
|-----------------------|-----------|
| REVISIONS:            | DATE:     |
| REVISION:             | 4/22/2015 |
| FOR: BID/CONSTRUCTION |           |
|                       |           |
|                       |           |

DRAWN BY:  
KRF  
DRAWING NAME:  
Kish-Manor  
Plans.dwg



KISHWAUKEE LANE & MANOR DRIVE  
OF  
CURB, GUTTER & SIDEWALK REPLACEMENT  
FOR  
DEKALB TOWNSHIP

SHEET TITLE:  
KISHWAUKEE  
LANE CROSS  
SECTIONS

SECTION:  
15-04122-00-RS

DATE:  
02/25/2015

SHEET NO.  
6 of 9

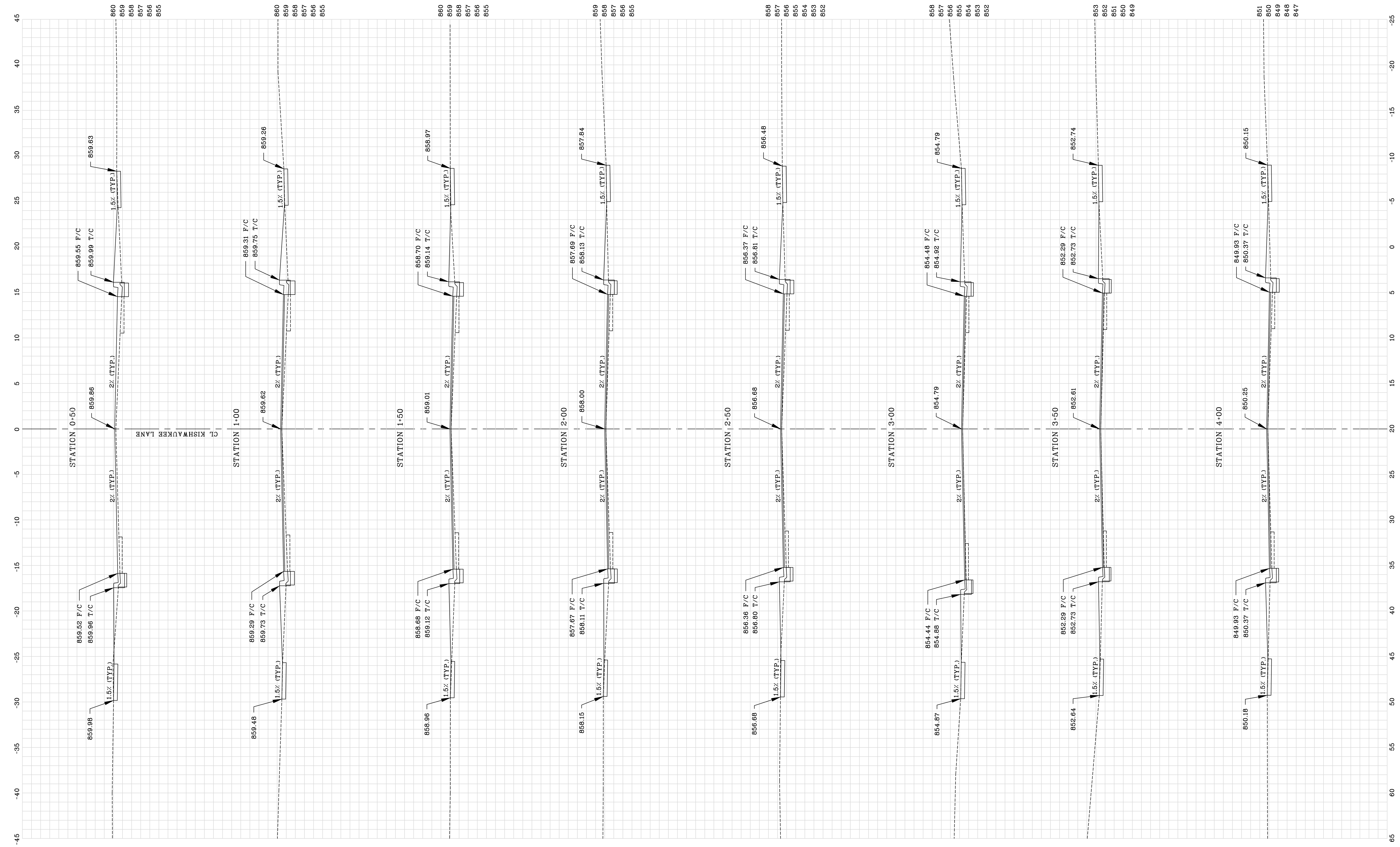

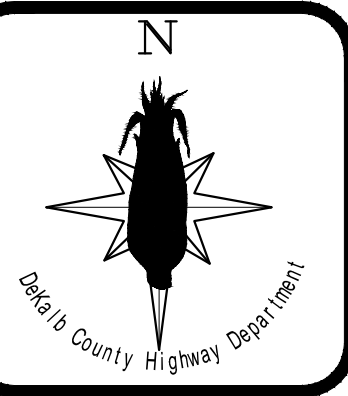
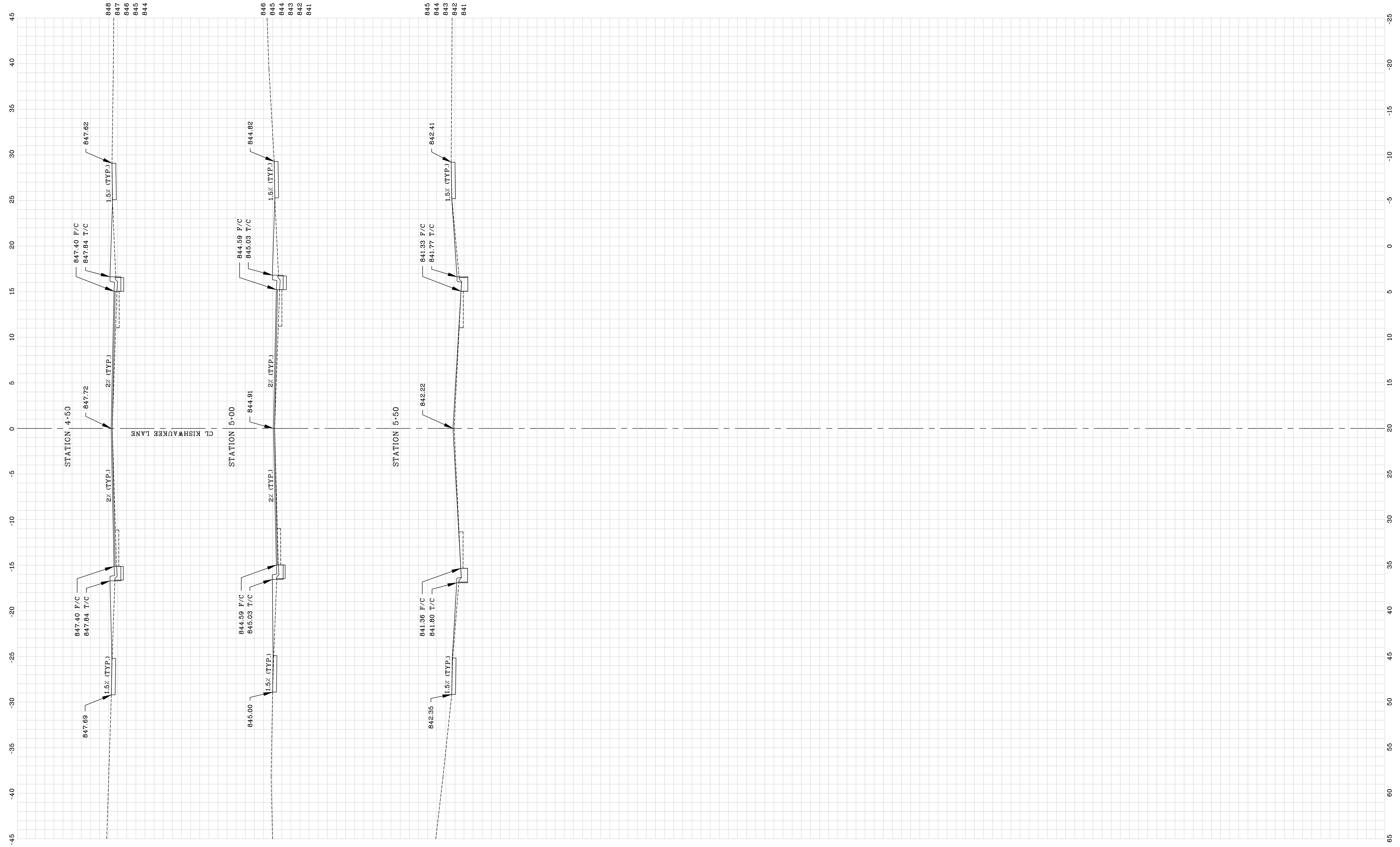

| REVISIONS:           |           |
|----------------------|-----------|
| REVISION             | DATE      |
| FOR BID/CONSTRUCTION | 4/22/2015 |
|                      |           |
|                      |           |
|                      |           |

DRAWN BY:  
KRF

DRAWING NAME:  
Kish-Manor  
Plans.dwg



KISHWAUKEE LANE & MANOR DRIVE  
OF  
CURB, GUTTER & SIDEWALK REPLACEMENT  
FOR  
DEKALB TOWNSHIP

SHEET TITLE:  
KISHWAUKEE  
LANE CROSS  
SECTIONS

SECTION:  
15-04122-00-RS

DATE:  
02/25/2015

SHEET NO.  
7 of 9

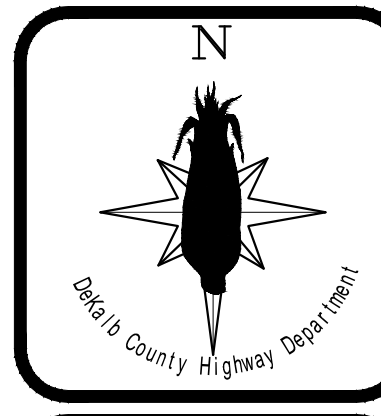
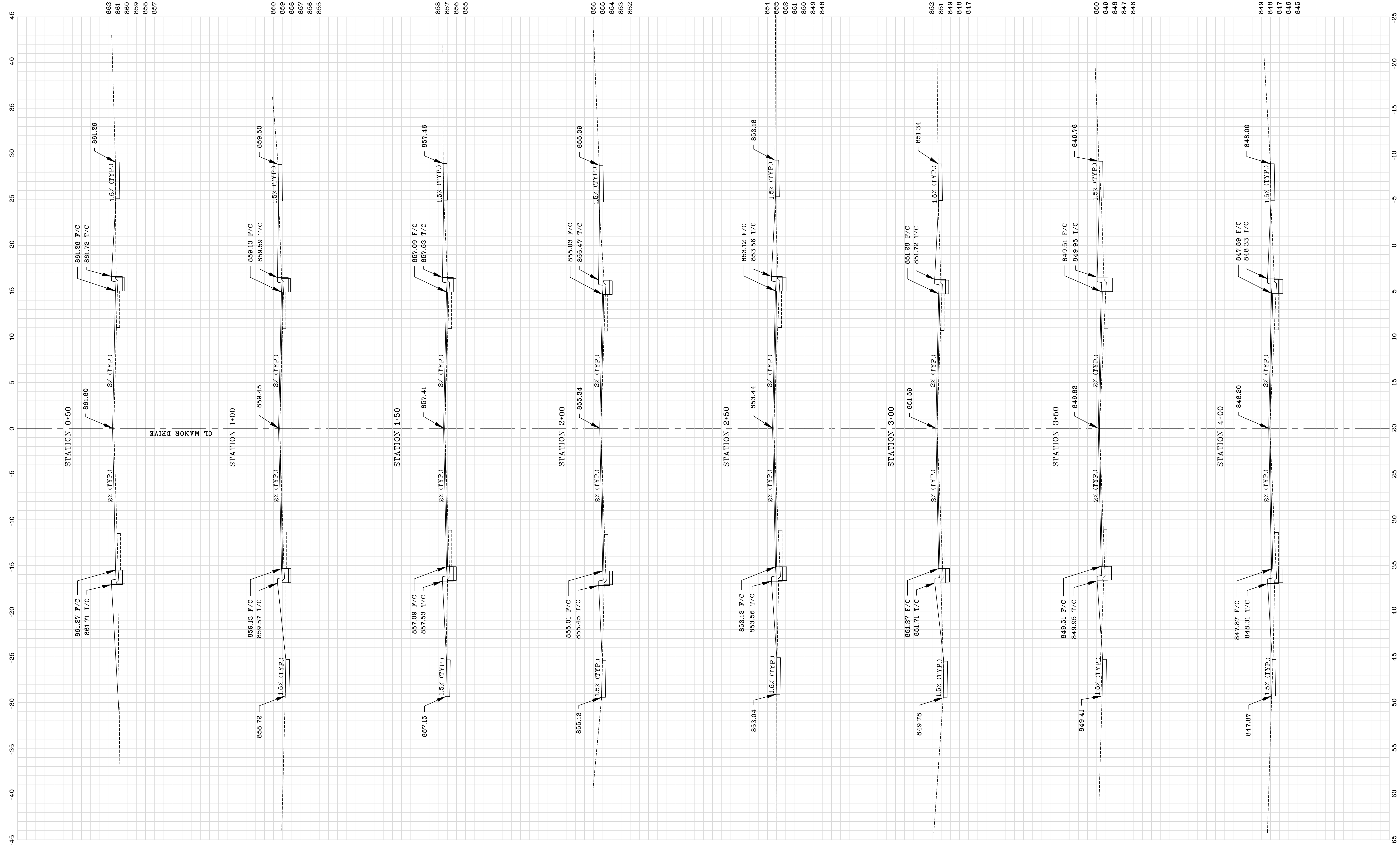

| REVISIONS:           |           |
|----------------------|-----------|
| REVISION:            | DATE:     |
| FOR BID/CONSTRUCTION | 4/22/2015 |
|                      |           |
|                      |           |

DRAWN BY:  
KRF

DRAWING NAME:  
Kish-Manor  
Plans.dwg



KISHWAUKEE LANE & MANOR DRIVE  
OF  
CURB, GUTTER & SIDEWALK REPLACEMENT  
FOR  
DEKALB TOWNSHIP

SHEET TITLE:  
MANOR DRIVE  
CROSS  
SECTIONS

SECTION:  
15-04122-00-RS

DATE:  
02/25/2015

SHEET NO.  
8 of 9



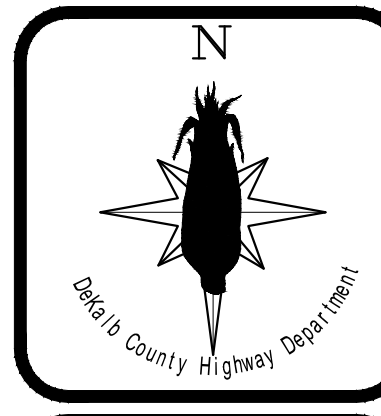
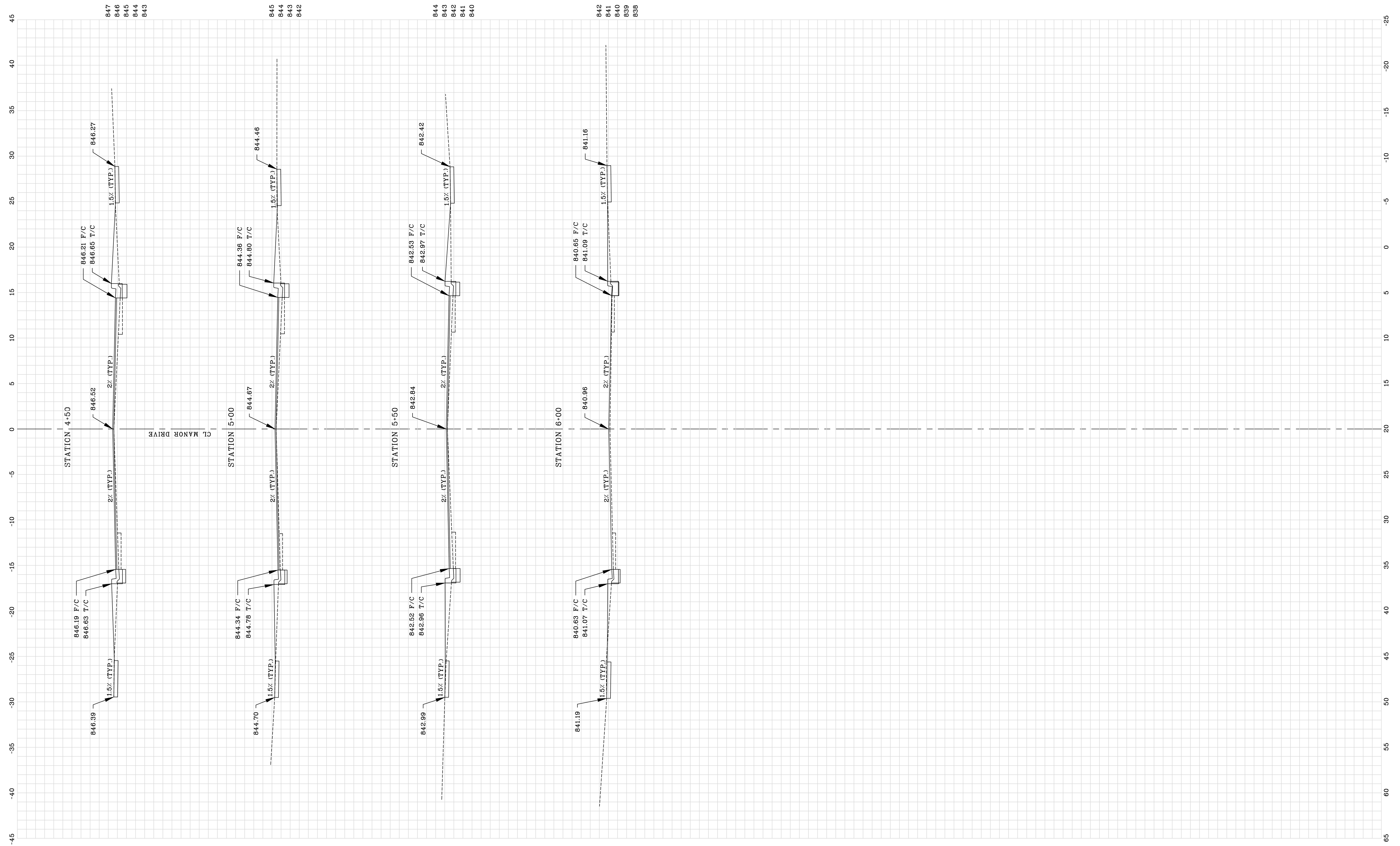

| REVISIONS:           |           |
|----------------------|-----------|
| REVISION:            | DATE:     |
| FOR BID/CONSTRUCTION | 4/22/2015 |
|                      |           |
|                      |           |

DRAWN BY:  
KRF  
DRAWING NAME:  
Kish-Manor  
Plans.dwg



KISHWAUKEE LANE & MANOR DRIVE  
OF  
CURB, GUTTER & SIDEWALK REPLACEMENT  
FOR  
DEKALB TOWNSHIP

SHEET TITLE:  
MANOR DRIVE  
CROSS  
SECTIONS

SECTION:  
15-04122-00-RS

DATE:  
02/25/2015

SHEET NO.  
9 of 9