



DEKALB COUNTY HIGHWAY DEPARTMENT

Office of
County Engineer
1826 Barber Greene Road
DeKalb, Illinois 60115

NATHAN F. SCHWARTZ, P.E.
County Engineer

Office Phone: (815) 756-9513
Fax: (815) 756-8705

TO WHOM IT MAY CONCERN:

DATE: April 4, 2016

REF: DeKalb County Bid Letting Scheduled for April 7, 2016 Section
2016 DeKalb County Patching Proposal

This letter will serve as notice that an addendum to the above referenced project has been published. Enclosed is a revised Special Provisions for the 2016 DeKalb County Patching Proposal. Please remove and destroy the current special provisions and replace it with the attached and add highway standard B.L.R. 22-7 that is also attached.

Article 442.01 specifies the Type of patches are based on lane width. We will allow the contractor to close the road where the patch covers both lanes. This would allow the contractor to work on both halves of the patch at the same time. Therefore the patches shall be listed and bid at a potentially single larger Type patch rather than two smaller Type patches.

In addition a copy of this letter is to be attached to any bid proposal returned by your company as proof of receipt thereof.

If you have any questions concerning the addendum please to do not hesitate to contact this department and speak with Brad Hunold.

Very truly yours,

A handwritten signature in black ink, appearing to read "Nathan F. Schwartz", is written over a horizontal line.

Nathan F. Schwartz, P.E.
County Engineer

BH
Enc

The following Special Provisions supplement the "Standard Specifications for Road and Bridge Construction", Adopted April 1, 2016, the latest edition of the "Manual on Uniform Traffic Control Devices for Streets and Highways", and the "Manual of Test Procedures of Materials" in effect on the date of invitation of bids, and the Supplemental Specifications and Recurring Special Provisions indicated on the Check Sheet included here in which apply to and govern the construction of Section 16-00000-06-GM, and in case of conflict with any part, or parts, of said Specifications, the said Special Provisions shall take precedence and shall govern.

DESCRIPTION OF WORK The work for this section shall consist of completing pavement patching on various routes throughout DeKalb County.

PROSECUTION OF WORK The Contractor shall notify the Engineer a minimum of two (2) working days (i.e. notice given on Thursday AM for work to begin the following Monday) prior to the commencement of any work which could be considered as a pay item in the contract. No payment will be made to the Contractor for any pay item work performed without the aforementioned notice being given unless otherwise approved by the Engineer.

TRAFFIC CONTROL Any cost associated with this work or any and all traffic control standards included in this proposal shall be considered incidental to the pay items in this proposal.

MOBILIZATION - Section 671 in the Standard Specifications shall be deleted and no advance payment for Mobilization shall be granted.

CLASS D PATCHES, 2 INCH This work shall be done in accordance to Section 442 of the Standard Specifications with the following exceptions. This work shall consist of 2 inches of pavement removal and the placement of 2 inches of Hot Mix Asphalt, Surface Course, Mix C, N50 on county roads. The surface of the patch shall be completed to the same elevation as the surrounding roadway. The sizes of patches are listed on the following spreadsheet.

Patches exceeding one lane width may be completed with the road closed to traffic and shall be measured as one larger patch rather than two smaller patches. **Article 442.01** shall be changed to "For each of the above classifications, the work on any size patch shall be further quantified by size as follows."

This work shall be paid for at the contract unit price per square yard of CLASS D PATCHES, TYPE IV, 2 INCH, which price shall include saw cutting, removal and disposal of the existing pavement and replacing with Hot Mix Asphalt Surface Course and all material, labor and equipment necessary to complete the work described above.

QUANTITIES The agencies reserve the right to determine the exact amount of patching to be completed; however, estimated quantities for each item are given in the proposal.

SPECIAL PROVISION FOR BIDDING REQUIREMENTS AND CONDITIONS FOR MATERIAL PROPOSALS (LRS7) Requirement of Contract Bond Revise to read: successful low bidder has submitted a proposal guaranty check, it will be held by the County as the contract bond. The Contractor's check will be held until the successful completion of the work and certification of material approval, upon which time, the check will be returned to the Contractor.

PREVAILING WAGE The Contractor(s) shall pay prevailing wage to employees on this project in accordance with LR107-7. The Contractor shall be responsible for obtaining the monthly rate sheet from the Illinois Department of Labor. These sheets are also available at the DeKalb County Clerk's office or at: <http://www.illinois.gov/idol/>.

INSURANCE The successful bidder shall furnish a Certificate of Insurance, with the minimum requirements listed below, within 30 days of the award or the bid will be considered null and void.

1. Bodily Injury Liability - \$1,000,000
2. Property Damage Liability
 - A. Each Occurrence - \$500,000
 - B. Aggregate - \$1,000,000
3. Workmen's Compensation Coverage



COMPLETION DATE The patches on Old State Road and Malta Road shall be completed by June 30, 2016. The remaining patches shall be completed by August 31, 2016.

**CONDITION I
APPROACH TRAFFIC STOPPED**

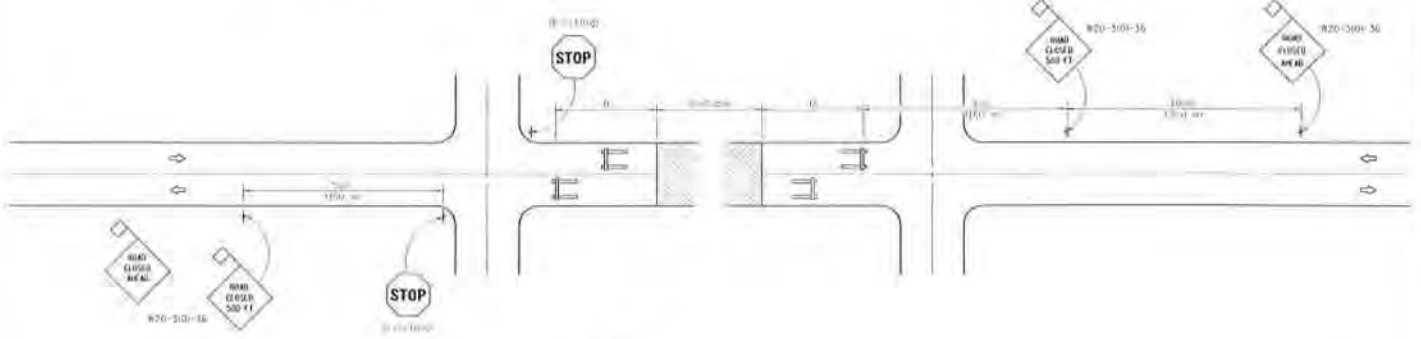
**CONDITION II
APPROACH TRAFFIC DOES NOT STOP**



SYMBOLS

-  Barricade
-  Type III Barricade
-  Sign with 18" (450x450) min. orange flag attached

GENERAL NOTES

Type III Barricades and R11-4-6030 signs shall be positioned as shown in the Road Closed to All Traffic detail on Highway Standard 10950. If the distance "D" exceeds 2000' (600 m), an additional set of barricades and R11-4-6030 shall be placed at each end of the work area.

Two Type A Low Intensity Flashing Lights shall be used on each approach in advance of the work area. One light shall be installed above each barricade. If only one barricade is required, the other light shall be installed above the first barricade at 1000' (300 m).

All warning signs shall have minimum dimensions of 36" x 36" (900 x 900) and have a black legend on an orange reflectorized background.

When fluorescent signs are used, orange flags are not required.

Longitudinal dimensions may be adjusted to fit field conditions.

All dimensions are in feet unless otherwise indicated.

 Texas Department of Transportation
 Project: TX 360-1302-0001
 Drawing: 22-7
 Date: 11/11/11
 Author: [Name]
 Checker: [Name]

DATE	REVISIONS
11-11-11	Issued for review. See GENERAL NOTES.
11-11-11	Revised General Notes and standard symbols. See Project manual for details.

TYPICAL APPLICATION OF TRAFFIC CONTROL DEVICES FOR CONSTRUCTION ON RURAL LOCAL HIGHWAYS (TWO-LANE TWO WAY RURAL TRAFFIC) (ROAD CLOSED TO THRU TRAFFIC)

STANDARD B.L.R. 22-7